

BOYA

Desktop Microphone

桌面麦克风

BOYA K9

User Manual
用户手册

Statement

Please read this manual carefully before using, and strictly operate and store it in accordance with the instructions. Please save the manual for future reference. If you need further assistance than the user manual, please consult your retailer for help or email us at: support@boya-mic.com

Cautions

1. Do not use the microphone underwater or expose it to rain. Please store it in a cool, dry place.
2. Use and store the microphone at a normal temperature. Do not frequently move it between hot and cold environments. Please keep it away from heat sources such as heaters, ovens.
3. When using and storing, please keep away from dust and moisture.
4. Avoid harsh impacts and collisions on the microphone.
5. Do not position the microphone close to the speakers to prevent audio feedback.
6. For the best pick-up pattern, do not hold your hand against the microphone.

General Introduction

The K9, a desktop microphone, features RGB lighting and dynamic effects that create a fashion style and ambiance for your gaming or live show. It boasts a shock mount at the bottom to minimize handling noise, and includes a built-in foam to reduce plosive sounds. Its LED indicator allows you to instantly check the microphone's status, and a simple tap-to-mute function helps avoid embarrassing mishaps during a live show. This microphone offers three polar patterns, making it versatile for nearly any recording situation. It is equipped with a gain knob for quick adjustments to input sensitivity. The supplied adapter is compatible with 3/8" and 5/8" threads for most stands. The K9 microphone provides high-quality sound whether connected to a PC, PS5, PS4, or Mac.

Product Structure

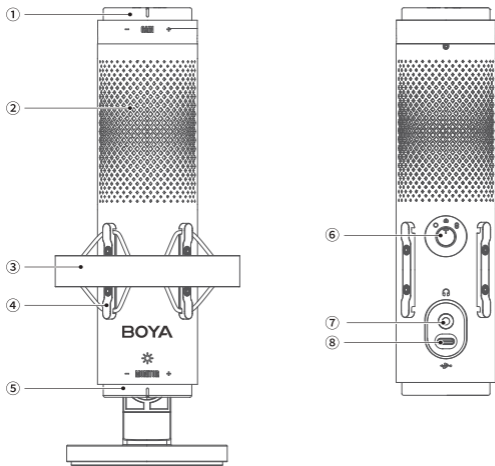

① Gain Knob / Mute Button / Noise Cancellation Button

- Gain: Rotate to adjust the microphone input gain.
- Mute: Lightly tap the top once to mute or unmute the microphone.
- Noise Cancellation: Press and hold the top to enable or disable noise cancellation.

② RGB Light

③ Shock Mount (with Pop Filter)

④ Adjustment Knob

Loosen this knob to adjust the microphone's angle for a better sound pick-up.

⑤ Headphone Volume Knob / RGB Lighting Effect Switch



- Rotate to adjust the headphone volume.
- It also functions as an RGB lighting effect switch to change various lighting effects.

Operation	Lighting Effect
Press and hold the microphone bottom	Turn the light on or off
Lightly tap the microphone bottom to cycle through the lighting effects	Purple light
	Dark blue light
	Light blue light
	Green light
	Yellow light
	Cyan-green light
	Red light
	White light
	Multi-color cycling
	Multi-color gradient transition

Note: Lighting effects cannot be switched while in mute mode.

⑥ Polar Pattern Knob

Rotate the knob to switch between three polar patterns: Omnidirectional, Cardioid and Bidirectional.

Polar Pattern	Description
Omnidirectional 	Captures sound from all directions around the microphone. It is ideal for recording ambient sounds or multi-person recordings.
Supercardioid 	Captures sound directly in front of the microphone. It is perfect for podcasts, live streaming, and other vocal recordings.
Bidirectional 	Captures sound from both the front and back of the microphone. It is great for face-to-face interviews and recordings.

⑦ 3.5 mm Headphone Jack

Connect headphones for audio monitoring.

⑧ USB-C Output Port

Used to output audio to devices like smartphones, tablets, or computers.

Pop Filter Installation

Align the bottom of the pop filter with the two slots on the shock mount and insert it into place as shown in the figure below.

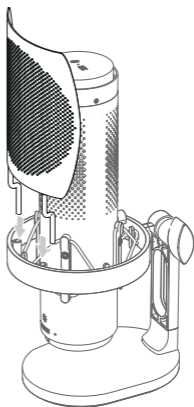

Boom Arm Installation

1) Rotate the adjustment knob counterclockwise to remove the microphone from the desktop stand.

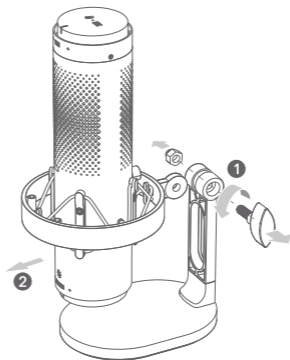

- 2) Using the included 5/8" to 3/8" threaded adapter to screw the microphone into the boom arm as shown in the figure below.

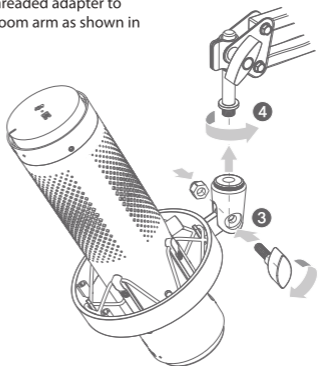

Operation Guide

Microphone Activation

Connect the microphone to your phone, computer, or other device using the included data cable. When connecting to a computer, you may need to configure program settings. For details, refer to the "Program Settings" section.

Microphone Placement

Place the microphone 5 to 15 cm (2"-6") away from the sound source and select the appropriate polar pattern to enhance recording quality.

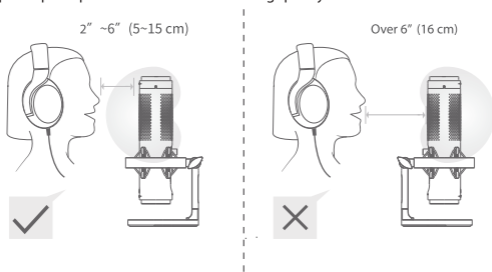

Mute Function

Lightly tap the top of the microphone once to mute or unmute the microphone. When muted, the RGB light will rapidly flash red.



Tap Once

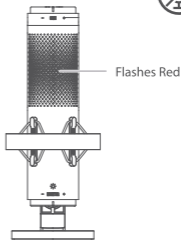

Gain and Headphone Volume Adjustment

Gain: Rotate to the right to increase gain; rotate to the left to decrease gain.

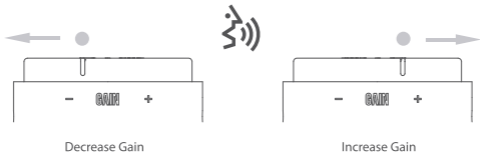

Headphone Volume: Rotate to the right to increase headphone volume; rotate to the left to decrease headphone volume.

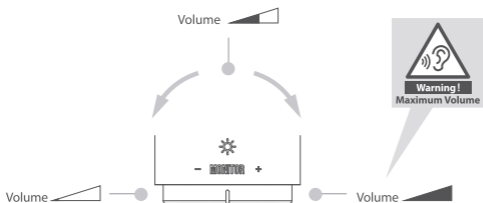

Noise Cancellation

Press and hold the top of the microphone to turn noise cancellation on or off. It is recommended to enable noise cancellation while recording in a noisy environment. The RGB light will rapidly flash green twice when noise cancellation is activated, and it will rapidly flash blue twice when noise cancellation is deactivated.



Press and hold to enable or disable noise cancellation

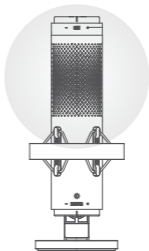

Program Settings

Mac System Program Setup

1. Connect the **K9** to your computer using the included data cable.
2. Open **System Preferences**, then select the **Sound** icon.
3. Choose **K9** as the input device under the **Input** tab.
4. Select **K9** as the output device under the **Output** tab.

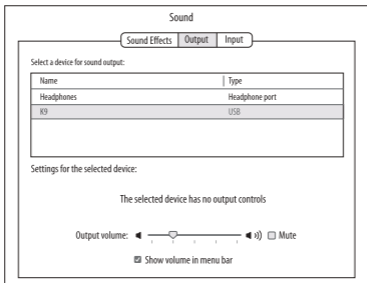
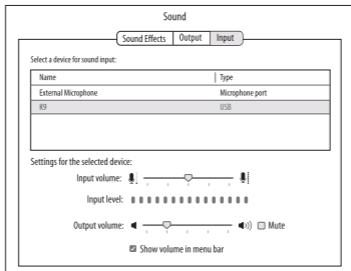

Windows System Setup

1. Connect the **K9** to your computer using the included data cable.
2. Go to **Settings > System > Sound**.
3. In the **Playback** tab, select **K9** as the default device.
4. In the **Recording** tab, select **K9** as the default device.

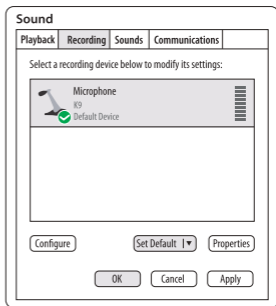
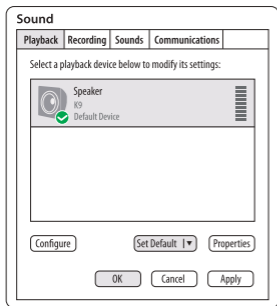

Specifications

Acoustic Principle	Condenser Microphone
Polar Pattern	Omnidirectional, Supercardioid , Bidirectional
Frequency Response	20 Hz to 20 kHz
Sensitivity (Maximum Gain)	-10 dBFS at 80 dB SPL
Sensitivity (Minimum Gain)	-46 dBFS at 80 dB SPL
Sampling Rate	48 kHz
Bit Rate	16/24 Bit
Maximum Sound Pressure Level (SPL)	108 dB SPL
Minimum Output Impedance	16 Ω
Port	3.5 mm headphone jack for monitoring, USB-C output (USB-C 2.0 Hi-Speed)
Dimensions	86 x 117 x 249 mm (Desktop Stand Included)
Weight	Approx. 599 g (Desktop Stand Included)
Power Supply	5 V, 200 mA (Max)
Operating System Requirements	Windows: 10.0 or later, macOS: 10.15 or later, Android: 9.0 or later, iPadOS*: 14 or later (Apple devices with a USB-C port are required)
Operating Temperature	0 °C to +40 °C (32 °F to 104 °F)
Storage Temperature	-20 °C to +70 °C (-4 °F to 158 °F); 10 to 95 %, not condensing

Polar Pattern

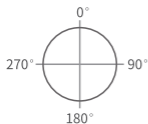

Omnidirectional

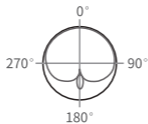

Supercardioid

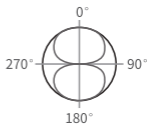

Bidirectional

Frequency Response

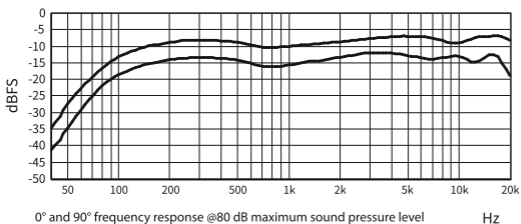

In the Box

K9 Microphone (with Shock Mount) × 1

Pop Filter × 1

Desktop Stand × 1

USB-C to USB-C / USB-A Data Cable (1.8 m) × 1

5/8" to 3/8" Threaded Adapter

声明

感谢您选择BOYA!

请在使用前仔细阅读本手册，并严格按照说明进行操作和存储。请妥善保存好说明书以供将来参考。如果用户手册不能帮助您解决某些问题，请向零售商寻求帮助或给我们发送电子邮件：support@boya-mic.com

注意事项

1. 不要在水下使用本机，不要将其暴露在雨中。请存放在阴凉干燥处。
2. 请在常温下使用并保存。不要频繁地将其从过热状态移至过冷状态，并远离热源，如加热器、烤箱或其他产生热量的设备。
3. 在使用和储存时，请注意防尘和防潮。
4. 小心避免猛烈的碰撞。
5. 为避免声音反馈，请勿将麦克风靠近扬声器。
6. 为获得最佳拾音模式，请勿将手放在麦克风上。

概述

K9是一款USB电容式麦克风，机身自带RGB照明和动态效果，可为游戏或直播间增添风格或氛围感；底部具有防振减震底座，有助于消除日常生活中的碰撞噪声，并内置防风海绵以消除爆音。使用LED指示灯立即了解您的麦克风状态，只需点击静音即可避免尴尬的直播事故。这款话筒有三种可选的拾音模式，几乎可以用于任何录制情况，并配有增益旋钮，可快速调节输入灵敏度。附带的安装适配器适用于3/8"和5/8"螺纹尺寸，与大多数支架兼容。它适用于多平台，因此无论您连接到PC、PS5、PS4还是Mac，都可以提供高质量的声音输出。

产品结构

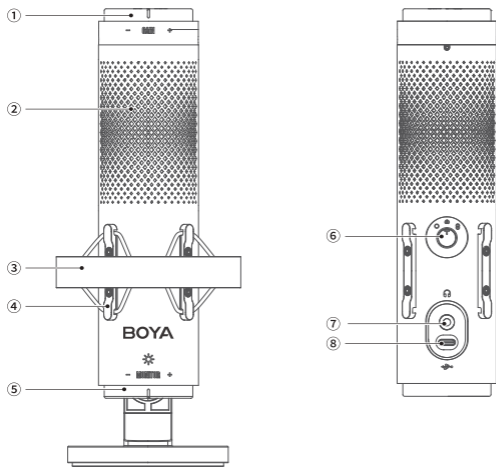

① 增益旋钮 / 静音键 / 降噪键

- 增益: 转动可调节麦克风录入增益。
- 静音: 轻触一下顶部开启或关闭静音。
- 降噪: 长按顶部开启或关闭降噪。

② RGB氛围灯

③ 防震支架(带防喷网)

④ 紧固旋钮

可通过调整该旋钮的松紧度来调节麦克风的角。

⑤ 耳机音量旋钮 / RGB灯效切换键



旋转可调节耳机音量。同时也可用作RGB灯效切换键可切换不同的灯效:

操作	灯效
长按底部	开启 / 关闭灯效
轻触底部循环切换	紫灯
	深蓝灯
	浅蓝灯
	绿灯
	黄灯
	青绿灯
	红灯
	白灯
	虹光
	反弹

注：静音状态下无法切换灯效。

⑥ 拾音模式切换旋钮

旋转旋钮，可依次调节为全向型、心型和8字型三种拾音模式：

拾音模式	说明
全指向型 	拾取麦克风全方位的声音。非常适合录取环境声或多人录制。
超心型 	拾取麦克风正前方的声音。非常适合播客、直播和其他人声录制。
8字指向型 	拾取麦克风前后方的声音。非常适合两人面对面采访、录制。

⑦ 3.5 mm耳机监听孔

接入耳机进行音频监听。

⑧ USB-C输出接口

用于输出音频至智能手机、平板或电脑等设备。

防喷网安装

将防喷网底部对准防震架前方两个插口插入，即可固定

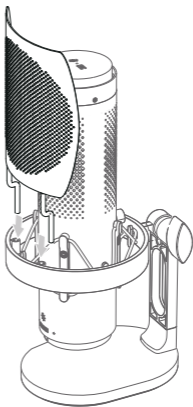

悬臂安装

1) 逆时针旋转紧固旋钮将麦克风从桌面支架上取出；

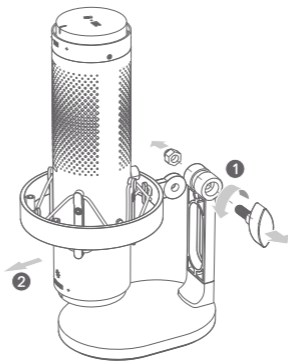

2) 通过5/8" 转3/8" 螺纹接头, 如下图所示将麦克风安装至悬臂支架上。

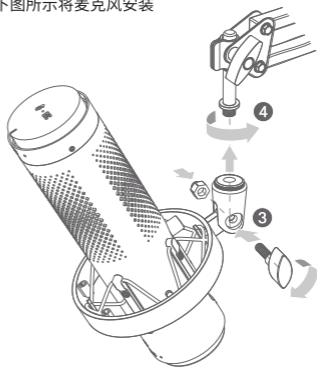

操作指南

启用麦克风

使用配套的一分二USB-C转USB-C / USB-A数据线连接麦克风至手机、电脑等。连接电脑使用需设置程序，详情请参考“程序设置”。

拾音规范

请将麦克风放置在声源的5 - 15 cm处，并选择合适的拾音模式提高录制效果。

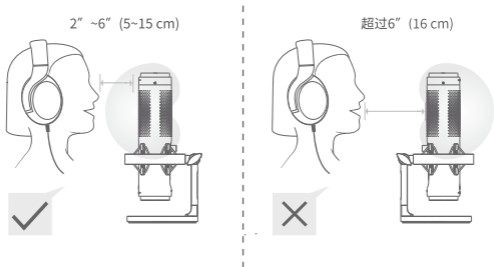

静音

轻触一下麦克风顶部开启或关闭静音。静音开启后，RGB灯呈红灯快闪。

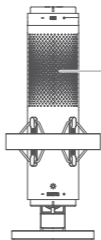

红灯
闪烁

调整增益和耳机音量

- 增益：向右旋转增益旋钮增大增益；向左旋转减小增益。

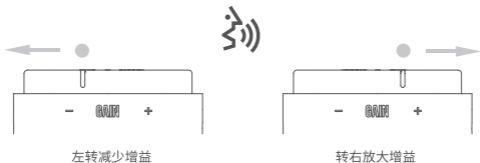

- 耳机音量：向右旋转增大耳机音量；向左旋转减小耳机音量。

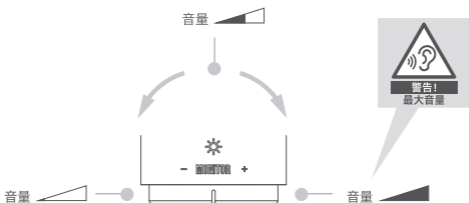

降噪

可长按麦克风顶部开启 / 关闭降噪。若录音环境较为嘈杂，建议开启降噪功能。降噪开启后，RGB灯呈绿灯快闪2次；降噪关闭后，RGB灯呈蓝灯快闪2次。



程序设置

Mac系统程序设置

1. 使用随附的数据线将K9接入电脑；
2. 打开“系统偏好设置”，然后选择“声音”图标；
3. 选择“K9”为输入设备；
4. 选择“K9”为输出设备。

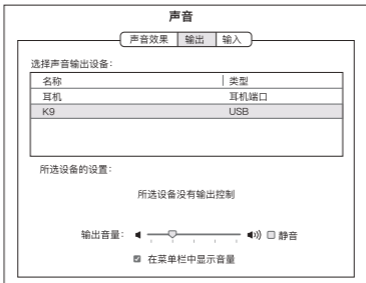

Windows系统程序设置

1. 使用随附的数据线将K9接入电脑；
2. 进入设置>系统>声音；
3. 在“播放”选项卡下选择“K9”为默认设备；
4. 在“录制”选项卡下选择“K9”为默认设备。



参数

声学原理	电容麦
拾音模式	全向型 / 超心型 / 8字型
频率响应	20hz~20khz
灵敏度(最大增益)	-10dBfs at 80 dB spl
灵敏度(最小增益)	-46dBfs at 80 dB spl
采样率	48kHz
比特率	16/24 Bit
最大声压级	108 dB SPL
最小输出阻抗	16 Ω
接口类型	3.5mm耳机监听孔
	USB-C输出接口(USB 2.0 高速)
尺寸(带支架)	86 x 117 mm x 249mm
重量(带支架)	599 g
电源要求	最高支持5 V, 200 mA
兼容系统	Windows: 10.0 或以上, macOS: 10.15或以上, Android: 9.0 或以上, iPadOS*: 14或以上 (需要支持USB-C的苹果设备)
工作温度	0 °C to +40 °C (32 °F to 104 °F)
贮存温度	-20 °C to +70 °C(-4 °F to 158 °F); 10 to 95 %, 不冷凝

极性模式

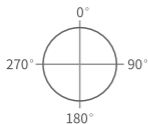

全向型

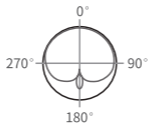

超心型

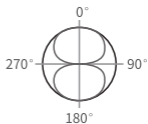

8字型

频率响应

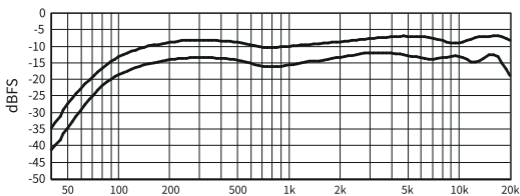

0° 和 90° 频率响应 @80 dB 最大声压级 Hz

包装清单

K9麦克风(含防震支架) × 1

防喷网 × 1

桌面支架 × 1

一分二USB-C转USB-C / USB-A数据线(1.8 m) × 1

5/8" 转3/8" 螺纹接头 × 1

SHENZHEN JIAYZ PHOTO INDUSTRIAL., LTD.

The BOYA logo is a trademark which is registered and owned by Shenzhen Jiayz Photo Industrial., Ltd.

深圳市长丰影像器材有限公司

地址:广东省深圳市龙华区观澜街道大富社区硅谷动力智能终端产业园A16栋

TEL: 400 6131096

Email: sales@boya-mic.com

www.boya-mic.com / www.jiayz.com